

# BAR / DOUBLE END STUD

PART# \_\_\_\_\_

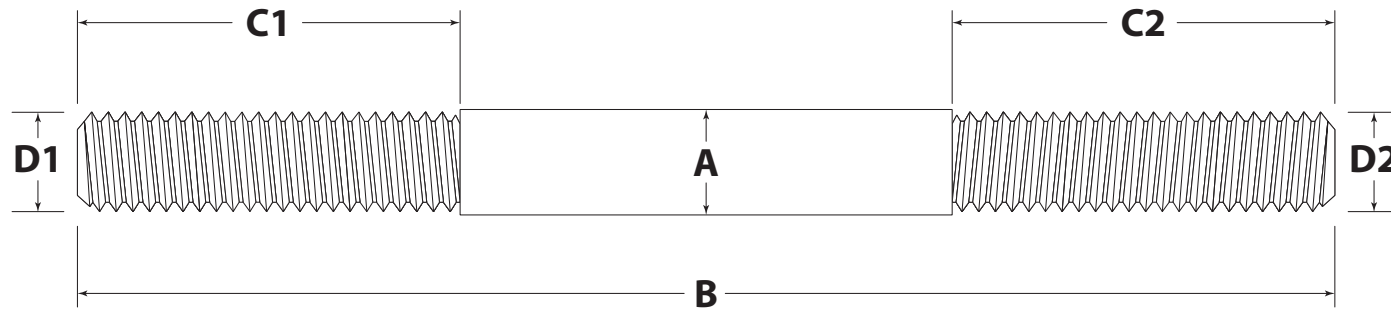

Dimension	Description	Value	Tolerance
A	Rod Diameter		Reference
B	Bar Length		+/- .125
C1	Thread Length		Minimum
C2	Thread Length		Minimum
D1	Thread Diameter		Reference
D2	Thread Diameter		Reference

D1 Thread Size/Pitch: \_\_\_\_\_  
Thread Type: RH / LH

D2 Thread Size/Pitch: \_\_\_\_\_  
Thread Type: RH / LH

Material: \_\_\_\_ 1045 Carbon Steel  
\_\_\_\_ 300 Series Stainless Steel

Finish: \_\_\_\_\_

Other Requirements: \_\_\_\_\_

\_\_\_\_\_

For safety information, rated capacities, weight, and safe lifting practices, visit [www.huyett.com/LiftingHardware](http://www.huyett.com/LiftingHardware).

## DESIGN APPROVAL

1. All prints must be signed and approved **before** production begins.
2. Specials cannot be returned. See terms and conditions at [www.huyett.com/terms](http://www.huyett.com/terms).
3. Send completed prints to [quotes@huyett.com](mailto:quotes@huyett.com).

NAME: \_\_\_\_\_

TITLE: \_\_\_\_\_

DATE: \_\_\_\_\_

SIGNATURE: \_\_\_\_\_



1215 E. 8th St.  
Minneapolis, KS 67467  
PH: 785.392.3017 Fax: 785.382.2845  
[www.huyett.com](http://www.huyett.com)

Rev.	Date	Comment	Drawn By:

**Note:** Hot Dipped Galvanized (HDG) parts threads will be undersized prior to coating.