

CLEVIS ASSEMBLY W/STRAIGHT ROD

PART# _____

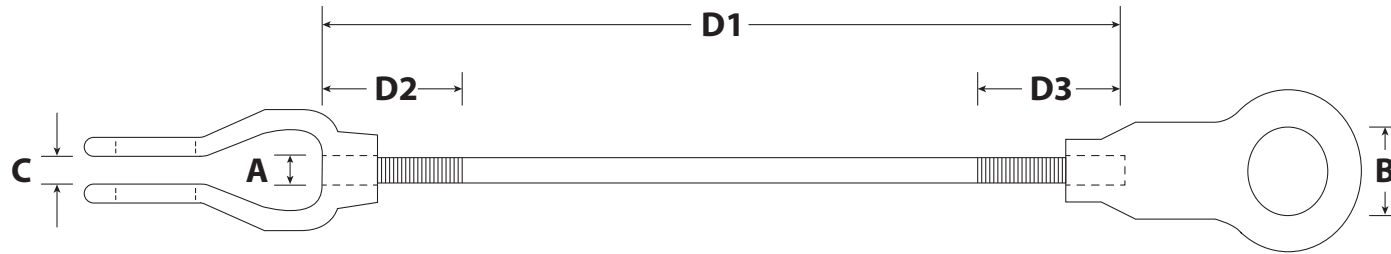

Unless otherwise noted, finished assembly includes 2 Clevis Pins with Cotter Pins.

Dimension	Description	Value	Tolerance
A	Thread Size		Typical – Select: RH / LH
B	Hole Size		+0.015 / -0
C	Grip		+/- .060
D1	Rod Length		+/- .125
D2	Rod Thread Length		Minimum – Select: RH / LH
D3	Rod Thread Length		Minimum – Select: RH / LH

Clevis Size: 2 2-1/2 3
 Tap Size/Pitch: _____
 Material: _____ 1045 Carbon Steel
 Finish: _____
 Other Requirements: _____

For safety information, rated capacities, weight, and safe lifting practices, visit www.huyett.com/LiftingHardware.

DESIGN APPROVAL

1. All prints must be signed and approved **before** production begins.
2. Specials cannot be returned. See terms and conditions at www.huyett.com/terms.
3. Send completed prints to quotes@huyett.com.

NAME: _____

TITLE: _____

DATE: _____

SIGNATURE: _____



1215 E. 8th St.
 Minneapolis, KS 67467
 PH: 785.392.3017 Fax: 785.382.2845
www.huyett.com

Rev.	Date	Comment	Drawn By:

Note: When Hot Dipped Galvanized (HDG) is specified, Internal Threads will be oversized and External Threads will be undersized. Unless otherwise requested, the Internal Threads on Hot Dipped Galvanized (HDG) parts may be plain or coated at the manufacturer's option.